

GREAT SUMMER HOME OPPORTUNITY

PAY LESS & GET MORE

**BUILD YOUR SPACIOUS NEW HOME ON THIS BEAUTIFUL
LARGE 2.5 ACRE RESIDENTIAL LOT IN SAND CASTLE COVE**

ONLY MINUTES FROM THE AVALON/STONE HARBOR BEACHES

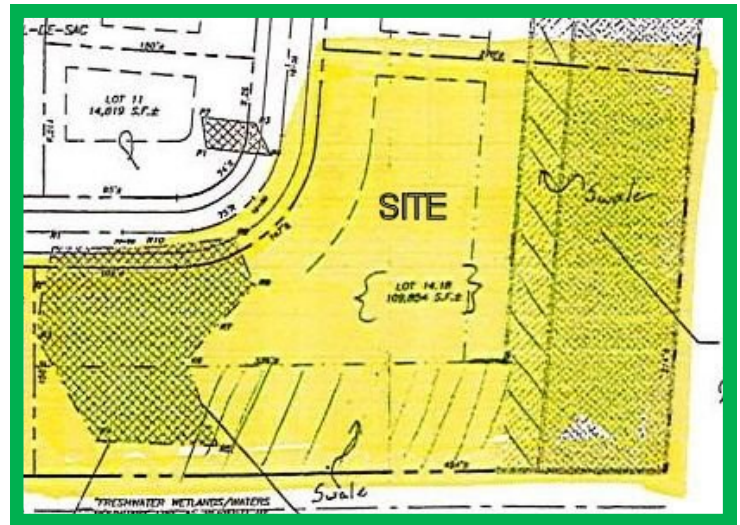

- **CONSTRUCT YOUR HOME WITH ALL YOUR DESIRED AMENITIES
AND STILL HAVE SIGNIFICANT AMOUNT OF OPEN SPACE FOR
SWIMMING POOL AND OTHER HOME ACTIVITIES**
- **ALL UNDERGROUND UTILITIES (GAS, PHONE, CABLE, ELECTRIC)**
 - **MUNICIPAL SEWER**
 - **WELL INSTALLED**
- **CLOSE TO MIDDLE TOWNSHIP SHOPPING DISTRICT & GARDEN STATE PARKWAY**



William J. Leahy
Cell: 609-827-4405
Main: 609-967-3001 Ext. 254
Email: Bill@BLeahy.com

**37 Sand Castle Drive
Cape May Court House, NJ**

ASKING: \$215,900